

## Rainscaping Program at March Meeting

Rainscapes, a unique word. In fact you will not find it in the Merriam-Webster or other dictionary. The term rainscapes, has been coined to describe landscaping projects designed to capture and infiltrate storm water runoff. In other words, this type of landscaping helps retain rain water in your yard rather than allowing it to run off into storm drains. By doing so, this retention improves water quality by preventing pollutants from leaving your property and eventually reaching our rivers and streams.

Erin Kubicek, Environmental Health Educator, Division of Watershed Management for the City of Lincoln Department of Transportation & Utilities, will share information about sustainable landscapes at our March 21<sup>st</sup> meeting. As a part of this program she will tell us more about the Rainscaping Lincoln – 2024 Sustainable Landscapes Cost Share Program. This program reimburses Lincoln property owners for 50% of qualifying expenses related to approved rainscaping projects, up to \$2000.

Whether you are interested in taking part in this program or not, Erin will share practical information about incorporating native shrubs, perennials and flowers into our landscapes, planting a rain garden, use of rain barrels, and how turf grasses and soil quality restoration combine to create a water wise lawn.

Erin will share examples of rainscaping projects that have been completed throughout the Witherbee neighborhood to inspire and challenge us.

**Circle Thursday, March 21st on your calendar and plan to attend the WNA meeting, 7 pm at Redeemer Lutheran Church, 510 S. 33rd St.**



Rain gardens capture runoff from hard surfaces like parking areas and driveways. The runoff filters into the surrounding soil, reducing the need for watering.

### WNA Calendar of Events

Feb. 15	5:30pm James Michael Bowers' Monthly Northeast Citizens' Meeting Anderson Library, 3635 Touzalin Ave.
Feb. 22	7:00pm WNA Monthly Meeting, Redeemer Lutheran Church, 510 S. 33 St.
March 21	5:30pm James Michael Bowers' Monthly Northeast Citizens' Meeting Anderson Library, 3635 Touzalin Ave.
March 21	7:00pm WNA Monthly Meeting, Redeemer Lutheran Church, 510 S. 33 St.
April 18	5:30pm James Michael Bowers' Monthly Northeast Citizens' Meeting Anderson Library, 3635 Touzalin Ave.
April 25	7:00pm WNA Monthly Meeting, Redeemer Lutheran Church, 510 S. 33 St.
May 4	8am-12pm Annual Neighborhood Clean-up, 48th & M Streets

### See Inside Stories:

<b>Woods Park Mediation Report</b>	<b>pg. 3</b>
<b>New Facebook Group!</b>	<b>pg. 5</b>
<b>Holiday Lights Contest</b>	<b>pg. 7</b>
<b>Crime Watch Needs You!</b>	<b>pg. 8</b>

**Witherbee  
Neighborhood Association**

**Boundaries:**

33rd to 56th & 'O' to Randolph

**Meetings:**

7:00 p.m. Check our Facebook page  
or website for meeting location.

[www.facebook.com/witherbeena](http://www.facebook.com/witherbeena)

[www.WitherbeeNA.org](http://www.WitherbeeNA.org)

PO Box 5431  
Lincoln, NE 68505  
402-413-0156

**WNA Board:**

Mike Kreikemeier, President  
402-802-7865  
[mbkreikemeier@gmail.com](mailto:mbkreikemeier@gmail.com)

Julie Flodman, Vice President  
402-805-9926  
[jsiffring@yahoo.com](mailto:jsiffring@yahoo.com)

Janice Swanson, Secretary  
402-417-5999  
[janice.swanson7@gmail.com](mailto:janice.swanson7@gmail.com)

James Burton, Treasurer  
531-210-9099  
[jamesdavidburton01@gmail.com](mailto:jamesdavidburton01@gmail.com)

Dawn Bevans  
[paisleydragon@gmail.com](mailto:paisleydragon@gmail.com)

James (Jim) Brewer  
402-800-8668  
[jabrewer46@gmail.com](mailto:jabrewer46@gmail.com)

Mike Fitzgerald  
402-416-1475  
[sevenfranch@windstream.net](mailto:sevenfranch@windstream.net)

Fred Freytag  
402-480-8655  
[fred@witherbeena.org](mailto:fred@witherbeena.org)

Margaret Indriksons  
402-217-4882  
[mindriks@aol.com](mailto:mindriks@aol.com)

Kathie Johnson  
[kathierayjohnson@gmail.com](mailto:kathierayjohnson@gmail.com)

Jean Klone  
[jmklone@icloud.com](mailto:jmklone@icloud.com)

Rod Lane  
402-499-0807  
[dcerod@redeemerlincoln.org](mailto:dcerod@redeemerlincoln.org)

Terri Marti  
402-430-5582  
[martiterri@gmail.com](mailto:martiterri@gmail.com)

Janice Swanson  
402-417-5999  
[janice.swanson7@gmail.com](mailto:janice.swanson7@gmail.com)

**Newletter:**  
April Stevenson  
[aprilannstevenson@gmail.com](mailto:aprilannstevenson@gmail.com)

Kathy Holland  
[rh30222@windstream.net](mailto:rh30222@windstream.net)

## President's Message

### Mike Kreikemeier



Hello, I am excited to once again be president of Witherbee Neighborhood Association. I have been involved with WNA for many years. It is a great organization that makes a great neighborhood even better.

I would like to thank the board members and especially past president Kathy Holland. Kathy did a wonderful job and I applaud her efforts keeping WNA moving forward even during the Covid Pandemic.

I want to welcome the new board members: Jim Brewer, James Burton, Fred Freytag, Margaret Indriksons and Terri Marti and a big thanks to all of the continuing board members. I feel we can accomplish big things in the coming year.

This year WNA is focusing on connections. The first would be neighbor to neighbor connections that are made at WNA monthly meetings and events as well as meeting and greeting neighbors when you go for a walk or shovel snow off your driveway.

The second type of connection WNA will be working on is working with groups within the neighborhood. The Woods Park – Keep It Green is a dedicated group of neighborhood volunteers that is working on improving and guiding development of Woods Park. WNA has supported Keep It Green and wants to continue working with the Keep It Green group on keeping Woods Park a park for all neighbors to enjoy.

Another connection WNA is cultivating is with other neighborhood organizations. A few of the neighborhood organizations that WNA hopes to strengthen ties with are East Campus Community Organization, Woods Park NA, Near South NA, Irving NA and Hartley NA. Building ties to other organizations is a great way to share ideas and join together on common problems and issues.

It's January and time to renew your WNA membership. Please find the membership form in this edition of the Buzz or the membership letter that will be mailed in February. It is easy to fill it out and send it in along with a check. Or find the online link at [WitherbeeNA.org](http://WitherbeeNA.org) to join using PayPal. Joining WNA is a great bargain, for a reasonable membership fee you will join an energetic group of people improving the neighborhood where you live.

Of course, no President's message would be complete without saying a bit about how all of the good things Witherbee does get done. Surprise, the work is done by Volunteers! Yes, You can put your talents to work by joining your neighbors and helping at the Neighborhood Cleanup in May. Or the Garage Sales in June. Maybe you would be just the person that we need to make our famous Pool Party and Ice Cream Social a success in August. Witherbee NA is powered by volunteers. Please join us in making a great place to live even better.

### Connect with our neighborhood through Nextdoor

<https://nextdoor.com/neighborhood/witherbeestuhrpark--lincoln--ne/>

**Witherbee-Stuhr Park neighbors share recommendations and advice, classifieds, important alerts, and much more on Nextdoor.**

## Witherbee Team and the Woods Park Tennis Expansion Mediation

by Mike Kreikemeier & Mary Schwab

At the August WNA meeting a motion opposing changes to the Woods Park Master Plan to allow Friends of Woods Tennis to significantly expand the Woods Tennis Center was approved by a wide majority. A second motion was also approved to form a mediation team and work with The Mediation Center. The Mediation Center was hired by the Lincoln Parks & Recreation department to gather information and input on the design of the proposed expansion.

The WNA mediation team met with Carl Eskridge and Casey Karges at The Mediation Center on October 30 to discuss WNA's position of opposing the Tennis Center expansion and preserving the green space at Woods Park.

The Friends of Woods Tennis has submitted an updated proposal to Lincoln Parks & Rec. (See map below.) The Mediation Center scheduled an invitation-only meeting February 7 which included Lincoln Parks & Rec, Friends of Woods Tennis, Woods Park: Keep it Green, WitherbeeNA, Woods ParkNA and the HartleyNA mediation teams.

Future Mediation meetings will be announced using the WNA email and Woods Park Keep it Green and Witherbee Neighborhood Association Facebook pages. Please stay engaged and check those sites regularly for further information.

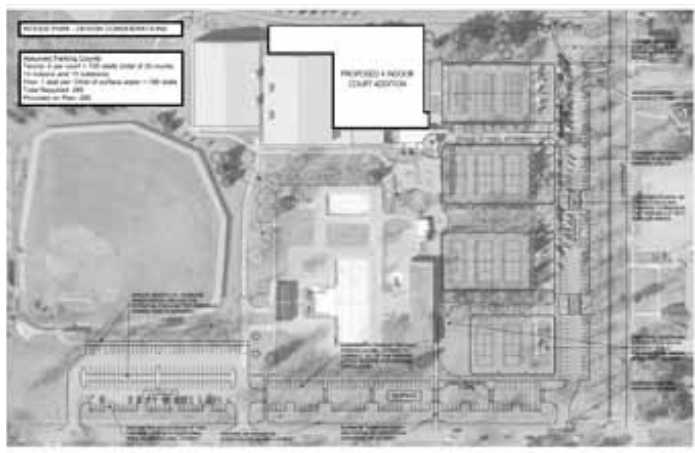

**Redeemer Lutheran Church**  
510 South 33rd Street,  
[www.redeemerlincoln.org](http://www.redeemerlincoln.org)

*Midweek Lenten Supper from 5 - 6pm*  
*Worship 6:30pm Wednesdays starting Feb 21*

*Register for Vacation Bible School*  
*starting in April online*

## Meeting our New Neighbors at S<sup>2</sup>age Living

by Kathy Holland

In early December a group of Witherbee Board members met informally with the first residents of S<sup>2</sup>age Living Community at 420 S 47th St. S<sup>2</sup>age Living opened in the fall of 2023 with a planned gradual move-in of residents over six months. This new state-of-the-art community built by Tabitha is designed to bring generations together by offering apartments to older adults (55+) and students of the Bryan College of Health Sciences.

Of the 128 apartments available, about 25 will be reserved for students. Shared spaces such as the community kitchen and the open-air rooftop terrace have been designed to promote intergenerational connections.

At our first meeting Mary Schwab, Julie Flodman, Kathie Johnson, Jean Klone and Kathy Holland shared information about WNA's activities and events, ways we connect with residents of Witherbee and how we hope to communicate with those living at S<sup>2</sup>age.

We will return to S<sup>2</sup>age in April to meet more residents and discuss further how we can work together.



- No minimum balance
  - No monthly service charge
  - **FREE** Debit Card
  - **FREE** ^ Online Banking with Account Alerts
  - **FREE** thank you gift
  - **Up to \$10 BUY BACK** of your old checks and/or debit card
- ...and MORE!

Visit us online at [westgate.bank](http://westgate.bank) for details on our Completely FREE Personal and Business Checking.

^ Your cell phone provider may charge additional fees for web access or text messaging.

 **WEST GATE BANK**  
Our interest is you



[westgate.bank](http://westgate.bank) | 402.434.3456





## WitherbeeNA Protects R-2 Zoning at South 38th & O Street

by Rick Bagby

One of the most significant protections for Witherbee real estate property was the down-zoning campaign by Witherbee Neighborhood Association in 2005 to gain an R-2 zoning on nearly all properties, which allows only single-family and duplex dwellings on each lot. Out of more than 1900 housing units in Witherbee, there are currently only 14 buildings with more than two units.

In December, 2023, WNA's government liaison committee met with NeighborWorks and appeared before the Lincoln Planning Department to successfully oppose the re-zoning of two properties at 102 and 110 S. 38th St. to an R-4 status. This action will instead make those properties an R-2 zoning like the rest of the neighborhood, and gives all residents of Witherbee the assurance that WNA is watching and acting in your behalf.

## Lincoln Pharmacy

Your Friendly Community Pharmacy!

3300 A Street

Open M-F: 8:30am-7pm / Sat: 10am-4pm

Easy prescription transfer .... Just Call!

**402-817-7978**

- Free Delivery • Full Service
- Personalized Care
- All Major Insurances • Medicare/Medicaid
- Drive Thru Window •

## Ast market

Your friendly & convenient neighborhood

On the corner of 33rd and "A"  
402-477-3633 • [astreetmarket.strikingly.com](http://astreetmarket.strikingly.com)  
Find us on Instagram and Facebook @

**CALL FOR FREE DELIVERY**



## Russ Meyer

REALTOR®

ASSOCIATE BROKER

**402.310.8262**

**RUSS@FDRG.NET**



Russ knows our Witherbee neighborhood and has helped many buyers and sellers. As a Lincoln native, Russ has a vested interest in selling Witherbee properties and getting top dollar. Ask Russ for a free market study of your home. With 12 years of sales, Russ is consistently listed in the top 100 REALTORS® in Lincoln!



**Seller or Buyer? Call Russ Meyer!**

**Spirit of America is "cooking" up Great Rates for you!**  
**We have your "recipe" for financial success!**

It's easy to apply for and receive a loan at Spirit of America! You can apply by phone, our website, or in person. Ask for Cheryl or Dannielle to apply today!

**Any new money secured loans of \$10,000 or more will qualify for up to an additional 1.00%\* rate discount off of our already low rates. Qualifying loan types are:**

- ★ Auto ★ Home Equity ★ Motorcycle
- ★ Boat ★ RV, Travel Trailer & 5th Wheel



325 N 52 St  
Lincoln NE  
402.467.1102



\*All loans subject to approval. Rates, terms and conditions subject to change and vary based on creditworthiness, qualifications and collateral conditions. New money loans only. Discount includes member relation discounts. Minimum loan amount is \$5,000. Cannot be combined with any other offer (except Annual Meeting Wooden Nickel). Final interest rates cannot go below the floor rates. Offer excludes all loans already financed at the Credit Union. The first payment due date may be extended up to 90 days from the date of funding. Interest accrues from the date of funding. Real Estate loans - property must be located in Nebraska. Offer available February 20 to March 29, 2024.

*Proudly serving Military, Federal, Postal Employees and their families.*

# 2023 WNA Survey Summation, Part 4

by Julie Flodman

Thank you for taking the time to complete the Witherbee survey. The total number of surveys completed in 2023, either on-line or by *hard copy* was 116.

Each of your comments were documented and will help to direct the future focus of the WNA.

Part 4 is the final summation of those 116 surveys and states the topics you would be interested in learning more about at the WNA monthly meetings.

The first four categories had multiple responders expressing interest in that topic.

## Crime/Safe Neighborhoods

Current safety/crime statistics presented by LPD

Video Cameras & Ring Doorbells

School Safety

Crime Watch

O Street Noise Abatement

## Neighborhood History

## Home & Garden, Landscape

Tree care, assessing health of older trees; tree removal costs & expertise

Community gardens or homeowner gardening in general

Building your own rain barrel

Soil regeneration; adding manure as compost

Tree & shrub care; Do's & Don'ts, growing, pruning

## Home Ownership

Property Valuations; Property Taxes

How to increase your home's curb appeal

How to slow down the rental property ratio

## Other Topics of Interest:

**Woods Park: Keep it Green/Update on Tennis Complex Expansion Plans**

## Home Improvement

Home Remodeling; what's the best investment

How-to lessons for easy home repair

Energy/money saving tips

Basement wall repair

## Planning for Retirement

Social Security & Retirement: when to start, what to know

Starting Medicare

Retirement advise and things-to-know

Do's & Don'ts of writing a Will

## City Government & Public Policy

Street repair concerns; Prioritizing road improvements

Current Public Policy or Concerns impacting Witherbee

How to improve or add more sidewalks

Invite City Office Speakers

Nebraska Economic Council Topics: Educational & Outreach

## Miscellaneous

How to deal with neighbor issues

Little Free Pantries and Libraries: speakers, maps & how to help

Local walking/biking trails

Learning about environmentally friendly materials

Environment conservation issues

Time management

Planning for Auto, Home and Health Insurance

## Witherbee Neighborhood New Social Facebook Page

WNA will roll-out a neighborhood social Facebook page February 16. This will be in addition to our FB page that highlights events & city related issues. Our social page will be an excellent way to get to know your neighbors from 33rd to 56th streets and every block in between.

Let's share happenings in the neighborhood!  
LIKE our page beginning Feb. 16!



**327-0705**

Hours:  
M.-F. 8-6  
Sat. 8-12

**Jeff Jacobson, DVM**  
4145 "O" Street  
Visit our website for useful information about your family pet. We Care.  
[www.jacobsonvet.com](http://www.jacobsonvet.com)



*It's all about you!*  
1391 S. 33rd Street  
Locally owned by our members who live, work, worship  
and attend school in Southeast Nebraska.  
402.436.5365 [www.MembersOwnCU.org](http://www.MembersOwnCU.org)

## 2023 Holiday Lights Winners!

Thanks to all the neighbors that decorated their homes for the Holidays. There was a total of 28 nominated homes for this year's event.

### Final category wins:

**Reason for the Season** - Marilyn Porkorney; 631 S 51st

**Can't Take My Eyes Off of You** - Jacob & Ada Samuelson; 4132 L St.

**LES Superior Customer** - Sven Derichs; 3449 N St.

**Visions of Sugar Plums** - Anthony & Stacey Schuman; 354 S 54th St.

**Simple Elegance** - Matthew & Heidi Martindale; 4310 Randolph

The winners received gift cards. All other nominated homes received a WNA key-chain along with a Thank-you for making our neighborhood BRIGHTER!

Congratulations to ALL the participants!



Can't Take My Eyes Off of You



LES Superior Customer



Reason for the Season



Simple Elegance



Visions of Sugar Plums

**HuVee**<sup>®</sup>  
EMPLOYEE OWNED

Full service floral

Pharmacy

Chinese

Italian

Bakery

produce

kitchen & delicatessen

full service meat and seafood

**5010 'O' • 402-483-7707**



## Have You Seen This on Randolph Street?

by Margaret Indriksons

### February Yard of the Month

As the author of the Yard of the Month articles, I was asked to write a short piece regarding a house at 39th and Randolph which decorates their yard differently each month. After quickly realizing what house it was, I said, "Sure, that's my house and I would be happy to write about it, and our front yard friend, Edy the Yeti."

During the pandemic, my grandson Donnie and I bought the six-foot plus tall metal Sasquatch silhouette figure. And while we love bigfoot, we wanted to set this apart and decided on it being a Yeti instead. We knew our mythical metal figure would be a perfect upgrade to a whimsical decor by dressing it up in a different theme every month. From a little yellow polka dot bikini and back to school garb to being a mummy and Thanksgiving turkey, there's nothing Edy fears giving a try.

Edy resides by our ash tree in front of 3838 Randolph. I live here with my daughter, Kate, her husband Toby and son Donnie. The house has been in the family since 1965, and I bought it a little more than 16 years ago. So if you're traveling by 39th and Randolph, we hope you enjoy our changing Edy the Yeti.



Latest sighting



## Meet the New Board Members



**Terri Marti** married Russ Free in 1983. They bought their home in 1985 and have lived in the Witherbee neighborhood for 38 years. Terri obtained her Bachelor of Science and Master of Education degrees from UNL, followed by a career that included teaching Special Education for many years. Twice in her teaching

career, Terri served as an itinerant working with infants and toddlers who had disabilities. Terri has also worked for Region V Services, Crete High School, East and NorthStar High Schools in Lincoln NE.

Terri and Russ adopted three children who are now all young adults including a grandson who is a sophomore at Northeast High School. Terri and Russ are season ticket holders for both Husker football and volleyball.

Terri enjoys meeting neighbors, which convinced her to support the Witherbee neighborhood even more by volunteering her time and skills toward serving on the WNA Board.



**Margaret Indriksons** has lived in the Witherbee neighborhood since 1965. Initially living with her parents on Randolph St. she later married and moved into her own home on Laura Ave.

Margaret retired after more than 30 years of teaching science at Lefler Middle School. She now works part-time at the

HyVee Kitchen on O street and is continuing her 26-year effort in her gardening business.

Margaret also volunteers for our neighborhood through coordinating the WNA *Yard of the Month* in *The Buzz*.



TABITHA

**Rehabilitation  
Home Health  
Senior Living  
Hospice**

**Your Answer for Senior Care**

CONTACT A SENIOR CARE EXPERT  
402.486.8520 | TABITHA.ORG

## Would you like to be a part of the Witherbee Neighborhood Crime Watch Team?

by Julie Flodman, Kathie Johnson & Jean Klone

It's simple: The Neighborhood Watch is a tried, tested and proven program involving cooperation between citizens and the police. As part of the Neighborhood Watch, you are encouraged to talk to with your neighbors, get to know them and report any suspicious activity or possible crime to the police, when you see it. This cooperation between citizens and the police is encouraged by the police and has resulted in a decrease of crime in the Neighborhood Watch group areas. The LPD has assured us, they would rather you reported a concern that may lead to nothing, than to not report it and a neighbor suffers loss, injury or damages.

In our efforts to create a listing of everyone in the neighborhood who would be interested in joining Crime Watch, please share your name, address with our Crime Watch Coordinator Julie Flodman: [jsiffing@yahoo.com](mailto:jsiffing@yahoo.com)

The only thing needed for those interested is to be willing to keep an eye out for things that seem out of place in your neighborhood and report them to the LPD non-emergency number: 402-441-6000.

Would you be willing to share your camera or doorbell videos with the Lincoln Police Dept. to help resolve an investigation? If so, please contact Julie at [jsiffing@yahoo.com](mailto:jsiffing@yahoo.com)

### LPD Crime Information & Links:

LPD Non-Emergency Number:

402-441-6000 or 402-475-3600

Crime Stoppers: [Lincolncrimestoppers.com](http://Lincolncrimestoppers.com)

Lincoln Police Department:

[Lincoln.ne.gov/City/Departments/Police/About-LPD/News-Releases](http://Lincoln.ne.gov/City/Departments/Police/About-LPD/News-Releases)

Lincoln Police Department Facebook Page: Events, Safety, Social Communication Link

[Facebook.com/lincolnpolicedepartment](https://www.facebook.com/lincolnpolicedepartment)

Lincoln Police Department Neighborhood Watch:

Contacts, Crime Prevention, Learn more about Crime Watch, Quarterly News Release...

[Lincoln.ne.gov/City/Departments/Police/Documents-Publications/Neighborhood-Watch](http://Lincoln.ne.gov/City/Departments/Police/Documents-Publications/Neighborhood-Watch)

Lincoln Police Department, Set-up YOUR Crime Mapping Alerts: [Crimemapping.com/Alerts](http://Crimemapping.com/Alerts)



**Thank you for helping. We hope you will join the effort to keep our neighborhood safe!**



*You may have received a letter from the Witherbee Neighborhood Association that included this form. This is your reminder to respond! As you renew or become a new member, please consider ways you might volunteer. There are many ways you can help that do not require a huge time commitment. Please join us and meet your neighbors!*

## Become a new member or renew your membership today!

### Membership Categories:

- \_\_\_ Household . . . . . \$20.00
- \_\_\_ Senior Household (55+) . . . . . \$15.00
- \_\_\_ Sponsor (listed once in Buzz newsletter) . . . . . \$50.00
- \_\_\_ Business (listed once in Buzz newsletter) . . . . . \$50.00

Date: \_\_\_\_\_ Phone: \_\_\_\_\_

Email: \_\_\_\_\_

My Preferred Method of Contact: \_\_\_ email \_\_\_ phone \_\_\_ text \_\_\_ physical mail

Mail this form along with your payment to: **WNA Treasurer, P.O. Box 5431, Lincoln, NE 68505.**  
You may also now pay your dues online at [www.witherbeena.org](http://www.witherbeena.org)

- \_\_\_ Newsletter Production (writing or photography)
- \_\_\_ Newsletter Ad Sales
- \_\_\_ Distribute Newsletters
- \_\_\_ Membership Committee
- \_\_\_ Neighborhood Clean-up (help day of the event)
- \_\_\_ Crime Watch Team
- \_\_\_ Garage Sales Committee
- \_\_\_ Pool Party/Ice Cream Social Committee
- \_\_\_ Yard of the Month

- \_\_\_ Holiday Lights Contest Committee
- \_\_\_ Witherbee Event Food Committee
- \_\_\_ Government Liaison Committee
- \_\_\_ Board of Directors (board member)

If you don't see something you're interested in here, please tell us your ideas and suggestions!

\_\_\_\_\_  
\_\_\_\_\_